



**It's a great pleasure for us to invite all drivers, mechanics and families to Eskilstuna and the EFRA 1/8 IC Track European Championship**

**Location:** Eskilstuna Motorsportcenter Gröndal Ring  
**Route guidance:** Eskilstuna European route 20 (E20) take exit 129  
**GPS coordinates:** 59.41177, 16.37289

**For further information please visit our website:** [www.mkeskil.se](http://www.mkeskil.se)

**Airports & Airlines:** [LINK](#)  
**Rental cars:** [LINK](#)  
**Race facility:** [LINK](#)  
**Hotels:** [LINK](#)

Our first choice is Clarion Collection Bolinder Munktell ( See presentation of the hotel via the link above) where we have blocked 50 rooms, Don't wait too long to make your reservation. When you make your room registration refer to: "MKEskil2016"

**Hostels, Bed & Breakfast:** [LINK](#)  
**Camping and cabins:** [LINK](#)

**Accommodation:** Track side camping is possible 100 SEK/night. Toilets and showers are available. Please be nice to book as soon as possible on mail address: [tavlingssamordnare@mkeskil.se](mailto:tavlingssamordnare@mkeskil.se)

**Eskilstuna Tourist Service, Rothoffsvillan, Tullgatan 4, +46 16 710 70 00**

**Currency converter:** [LINK](#)

*Cash payment at track in €, change will be given in Sek.*

<b>Race Officials:</b>	<b>Race Director:</b>	Tyrone Norrman
	<b>EFRA referee:</b>	Frank Mostery (EFRA)
	<b>National referee:</b>	Dallas Mathiesen
	<b>Timekeeping:</b>	Stefan Svensson
	<b>Technical Inspection:</b>	Kai Virkkala & Magnus Hedlund
	<b>Environmentally responsible:</b>	Wolfgang Kienzle
	<b>Track responsible:</b>	Tommy Broman

**Contact and info:** Patric Henriksson; [tavlingssamordnare@mkeskil.se](mailto:tavlingssamordnare@mkeskil.se)



**MK ESKIL**  
**RACE WAY**  
**INDOOR TRACKS**



**MKE**  
**GRÖNDAL RING**  
**OUTDOOR TRACKS**

**SVENSK**  
**BILSPORT**

**Track info:** The track and the Arena was built in the summer 2014 when MK Eskil moved from Arena Bredängen to Eskilstuna Motorsportcenter, Gröndal. It is probably one of the largest and fastest race tracks in the world with a possibility to build a number of different layouts.

The longest track layout is 538 meters. The straights and dosed bends are 6,4 meters wide and the reaming part of the track is 4.4 meters wide. The surface is a smooth and well drained tarmac.

**Pit area:** 100 places under roof. 230v outlets is available for each one. Adapter that fits the outlet is the driver's responsibility to bring.

**The electric current** in Sweden is 230 volts and 50 hertz. Plugs and sockets are the same as in the continental countries of the European Union.



**Food & refreshments:** Well assorted cafe on site for breakfast, lunch and dinner. Fast food, Pizza, Restaurants in close range in the city of Eskilstuna.

**Banquet:** A banquet will be held at Munktell Museum, Friday July 15, it is free for drivers, mechanics and family need to pay a minor fee.

**Video from Warm Up 2015:** [LINK](#)

**Rules:** According to EFRA Handbook 2016.

**Fuel:** Fuel can be bought at the track.

**Tires:** Control tires according to EFRA rules. **Brand:** Contact (Contact RC Tyres).

**Timekeeping:** RCM Ultimate, only AMB or other compatible personal transponder.

<b>Time Schedule:</b>	<b>Monday</b>	Controlled practice
	<b>Tuesday</b>	Controlled practice
	<b>Wednesday</b>	Controlled practice Technical inspection Opening ceremony
	<b>Thursday</b>	Timed practice in heats Technical inspection Qualifying round 1-2
	<b>Friday</b>	Qualifying round 3-5 Super pole Sub final128 and 64 Banquet
	<b>Saturday</b>	Rest of the Sub finals. Semi finals Finals Reward ceremony



**MK ESKIL**  
RACE WAY  
INDOOR TRACKS



**MKE**  
GRÖNDAL RING  
OUTDOOR TRACKS

**SVENSK**  
**BILSPORT**



# OVERVIEW OF THE RACE FACILITIES

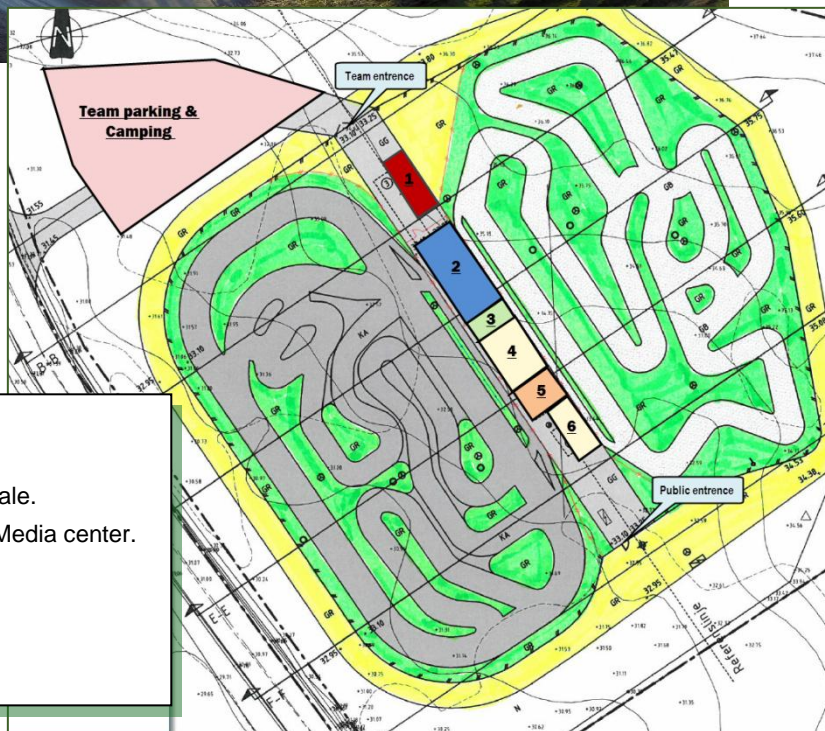

- 1: Compressed air for cleaning.
- 2: Mechanic-area for race teams under roof.
- 3: Technical inspection, Registration and Tire sale.
- 4: Upper deck: Drivers stand, Race controller, Media center.  
Floor level: Pit area and Tire true area.
- 5: Upper deck: Race directory and back office  
Ground floor: Catering and handicap toilet.
- 6: Toilet and shower building.

## SPONSORS



**MK ESKIL**  
RACE WAY  
INDOOR TRACKS



**MKE**  
GRÖNDAL RING  
OUTDOOR TRACKS

**SVENSK**  
BILSPORT